

### OD IMPERIAL

Size	a	b
1"	50,5	22,5
1 1/2"	50,5	35,3
2"	64,0	47,8
2 1/2"	77,5	60,5
3"	91,0	73,1
4"	119,0	97,7
4 1/2"	130,0	110,3
5"	144,4	123,0
5 1/2"	155,0	135,7
6"	167,0	147,2
6 5/8"	183,0	163,1
8"	218,0	197,6
8 5/8"	233,5	213,9
10"	268,0	247,4
10 5/8"	286,1	266,3
12"	319,0	298,2

- EPDM
- PTFE ENV/COEUR VITON
- PTFE ENV/COEUR EPDM
- SILICONE PLATINUM
- PTFE
- VITON
- GYLON BIOPRO BLUE

#### SUR DEMANDE

- FDA Cfr Title 21 Section 177.1550-2600
- USP XXII Class VI-121°C., Section 87 & 88, Biological Reactivity Test, in Vivo
- Batch-Nr Laser Marked = Traçabilité optimale (SILICONE and EPDM Gaskets only).
- 3-A Sanitary Standards
- USDA Standards
- Cytotoxicity Criteria
- E.P. 3.1.9 (European Pharmacopea) (pour SILICONE)
- USP <381> (pour EPDM et VITON)
- USP <661> (pour PTFE)

Ø 1/2" - 3/4"

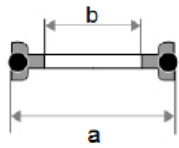

Ø 1" - 12"

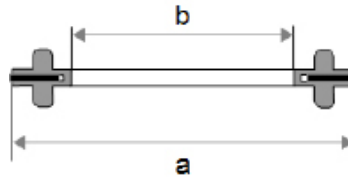

## OD IMPERIAL

Size	a	b
1/2"	22,0	10,2
3/4"	22,0	16,2
1"	50,5	22,5
1 1/2"	50,5	35,3
2"	64,0	47,8
2 1/2"	77,5	60,5
3"	91,0	73,1
4"	119,0	97,7
4 1/2"	130,0	110,3
5"	144,4	123,0
5 1/2"	155,0	135,7
6"	167,0	147,2
6 5/8"	183,0	163,1
8"	218,0	197,6
8 5/8"	233,5	213,9
10"	268,0	247,4
10 5/8"	286,1	266,3
12"	319,0	298,2

- EPDM
- PTFE ENV/COEUR VITON
- PTFE ENV/COEUR EPDM
- SILICONE PLATINUM
- PTFE
- VITON
- GYLON BIOPRO BLUE

### SUR DEMANDE

- FDA Cfr Title 21 Section 177.1550-2600
- USP XXII Class VI-121°C., Section 87 & 88, Biological Reactivity Test, in Vivo
- Batch-Nr Laser Marked = Traçabilité optimale (SILICONE and EPDM Gaskets only).
- 3-A Sanitary Standards
- USDA Standards
- Cytotoxicity Criteria
- E.P. 3.1.9 (European Pharmacopea) (pour SILICONE)
- USP <381> (pour EPDM et VITON)
- USP <661> (pour PTFE)

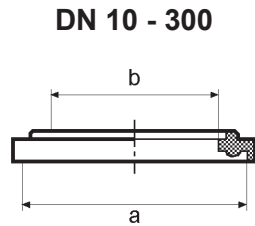

**DIN 32 676**

DN	a	b
DN 10	34,0	10,2
DN 15	34,0	16,2
DN 20	34,0	20,2
DN 25	50,5	26,2
DN 32	50,5	32,2
DN 40	50,5	38,2
DN 50	64,0	50,2
DN 65	91,0	66,2
DN 80	106,0	81,2
DN 100	119,0	100,2
DN 125	155,0	125,4
DN 150	183,0	150,4
DN 200	233,5	200,4
DN 250	268,0	250,2
DN 300	319,0	300,0

- **EPDM**
- **PTFE ENV/COEUR VITON**
- **PTFE ENV/COEUR EPDM**
- **SILICONE PLATINUM**
- **PTFE**
- **VITON**
- **GYLON BIOPRO BLUE**

**SUR DEMANDE**

- FDA Cfr Title 21 Section 177.1550-2600
- USP XXII Class VI-121°C., Section 87 & 88, Biological Reactivity Test, in Vivo
- Batch-Nr Laser Marked = Traçabilité optimale (SILICONE and EPDM Gaskets only).
- 3-A Sanitary Standards
- USDA Standards
- Cytotoxicity Criteria
- E.P. 3.1.9 (European Pharmacopea) (pour SILICONE)
- USP <381> (pour EPDM et VITON)
- USP <661> (pour PTFE)

DN 8 / 25 - DN 10 / 25

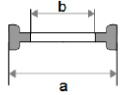

DN 8 / 34 - DN 10/34  
DN 15 - DN 300

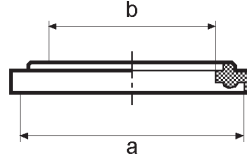

### ISO 1127

Size	a	b
DN 8 / 25	22,0	10,3
DN 8 / 34	34,0	10,3
DN 10 / 25	22,0	14,0
DN 10 / 34	34,0	14,0
DN 15 / 50,5	50,5	18,1
DN 15 / 34	34,0	18,1
DN 20 / 50,5	50,5	22,9
DN 20 / 50,5	50,5	22,9
DN 25 / 50,5	50,5	29,7
DN 32 / 50,5	50,5	38,4
DN 32 / 64	64,0	38,4
DN 40 / 64	64,0	44,3
DN 50 / 77,5	77,5	56,3
DN 65 / 91	91,0	72,1
DN 80 / 106	106,0	84,9
DN 100 / 130	130,0	110,3
DN 125 / 155	155,0	135,7
DN 150 / 183	183,0	163,1
DN 200 / 233	233,5	213,9
DN 250 / 286	286,1	267,8
DN 300 / 338	338,5	318,7

- EPDM
- PTFE ENV/COEUR VITON
- PTFE ENV/COEUR EPDM
- SILICONE PLATINUM
- PTFE
- VITON
- GYLON BIOPRO BLUE

#### SUR DEMANDE

- FDA Cfr Title 21 Section 177.1550-2600
- USP XXII Class VI-121°C., Section 87 & 88, Biological Reactivity Test, in Vivo
- Batch-Nr Laser Marked = Traçabilité optimale (SILICONE and EPDM Gaskets only).
- 3-A Sanitary Standards
- USDA Standards
- Cytotoxicity Criteria
- E.P. 3.1.9 (European Pharmacopea) (pour SILICONE)
- USP <381> (pour EPDM et VITON)
- USP <661> (pour PTFE)

## Clamp Screen gaskets



## ASME-BPE standards

Mesh	Micron Retention	Ouverture mailles (mm)
4	5156	5,16
6	3340	2,79
8	2464	2,46
10	1905	1,91
12	1532	1,53
16	1130	1,13
18	1081	1,08
20	864	0,86
24	703	0,70
30	516	0,52
40	381	0,38
50	318	0,32
60	233	0,23
80	140	0,14
100	140	0,14
120	118	0,12
150	103	0,10
180	83	0,08
200 x 200	74	0,07
250 x 250	61	0,06
325 x 325	40	0,04

- EPDM Ø 1/2" - 6"
- SILICONE PLATINUM Ø 1/2" - 6"
- VITON Ø 1/2" - 6"
- PTFE Ø 1/2" - 12"

### SUR DEMANDE

- FDA Cfr Title 21 Section 177.1550-2600
- USP XXII Class VI-121°C., Section 87 & 88, Biological Reactivity Test, in Vivo
- 3-A Sanitary Standards
- USDA Standards
- E.P. 3.1.9 (European Pharmacopea) (pour SILICONE)
- USP <381> (pour EPDM et VITON)
- USP <661> (pour PTFE)
- 3-A Sanitary Standards
- Material certificate EN 10204/3.1