

Clamp Coude 90° | *Clamp Bocht 90°*

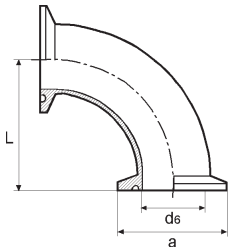

Inox 316L Poli/Gepolijst

Ra ≤ 0,4µm

Material certification 3.1



OD IMPERIAL

DIAM.	1/2"	3/4"	1"	1"1/2	2"	2"1/2	3"	4"
a	25	25	50,5	50,5	64	77,5	91	119
d6	9,4	15,75	22,1	34,8	47,5	60,2	72,8	97,2
L	88	88	50	70	88,9	108	127	168

DIN 32 676

DIAM.	DN 10	DN 15	DN 20	DN 25	DN 32	DN 40	DN 50	DN 65	DN 80	DN 100
a	34.0	34.0	34.0	50.5	50.5	50.5	64.0	91.0	106.0	119.0
d6	10.0	16.0	19.0	26.0	32.0	38.0	50.0	66.0	81.0	100.0
L	44.0	53.0	58.0	63.0	68.0	73.0	83.0	93.0	103.0	113.0

Clamp Té égal | *Clamp T-stuk*

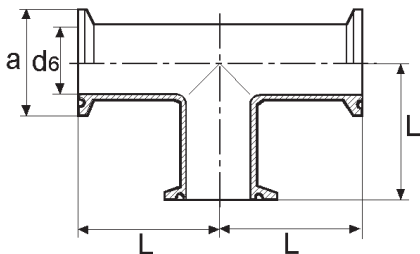

Inox 316L Poli/Gepolijst

Ra ≤ 0,4µm

Material certification 3.1



OD IMPERIAL

DIAM.	1/2"	3/4"	1"	1"1/2	2"	2"1/2	3"	4"
a	25	25	50,5	50,5	64	77,5	91	119
d6	9,4	15,75	22,1	34,8	47,5	60,2	72,8	97,2
L	66.6	66.6	60.3	69.9	88.9	88.9	95,3	114,3

DIN 32 676

DIAM.	DN 10	DN 15	DN 20	DN 25	DN 32	DN 40	DN 50	DN 65	DN 80	DN 100
a	34.0	34.0	34.0	50.5	50.5	50.5	64.0	91.0	106.0	119.0
d6	10.0	16.0	19.0	26.0	32.0	38.0	50.0	66.0	81.0	100.0
L	39.0	48.0	53.0	63.0	68.0	73.0	83.0	93.0	103.0	113.0